

## Thermovolt Shunts

High quality DC ammeter shunts made in Sweden since 1955. Thermovolt shunts are low resistance precision resistors for measuring current. When current flows through a Thermovolt shunt, a small voltage is developed, which is measured and corresponds to the current flowing through it.

Thermovolt shunts are designed, engineered and manufactured to exacting standards to offer the best possible performance and value.



## Best possible performance and value

---

**CONSTRUCTION** - THERMOVOLT SHUNTS ARE MADE OF MANGANIN RODS ANCHORED TO SOLID COPPER TERMINAL BLOCKS THROUGH A PROPRIETARY SILVER BRAISING PROCESS. THERMOVOLT'S CONSTRUCTION ASSURES THAT EACH SHUNT WILL ACHIEVE THE HIGHEST VIBRATION AND HIGH TEMPERATURE TOLERANCE OVER A LONG PERIOD. THE SILVER SOLDER IS APPLIED AT 620°C COMPARED TO USING TIN SOLDER NORMALLY APPLIED AT 200°C.

---

**COPPER TERMINAL BLOCKS** - THE SHUNT'S TERMINAL BLOCKS ARE MADE OF PURE COPPER STOCK TO ENSURE EVEN CURRENT DISTRIBUTION OVER ALL THE SHUNT RODS.

---

**NICKEL PLATING** - THERMOVOLT SHUNTS ARE NICKEL PLATED (.04 MICRONS THICK) TO PROVIDE EXTREMELY HIGH CORROSION RESISTANCE.

---

**VOLTAGE SCALE** - STANDARD THERMOVOLT SHUNTS ARE AVAILABLE WITH 100MV, 50MV OR 30MV VOLTAGE SCALES FACTORY CALIBRATED WITH +/- 0.5% ACCURACY. HIGHER PRECISION ACCURACIES ARE AVAILABLE.

---

**CURRENT RATING** - CAPABLE OF HANDLING CURRENTS UP TO 75% OF THEIR MARKED CURRENT RATING. THIS IS 12% GREATER THAN OTHER BRANDS, WHICH ARE RATED AT ONLY 66%.

---

**CONFIGURATIONS** - THERMOVOLT OFFERS A FULL LINE OF SHUNTS, IN STANDARD AND CUSTOM CONFIGURATIONS UP TO 40,000 AMPS.

---

**AIRFLOW** - RODS ALLOW FOR BETTER AIRFLOW THAN BLADES FOUND IN OTHER BRANDS.

---

**QUALITY** - EXACTING STANDARDS AND PRECISION CONSTRUCTION THAT INSPIRE CONFIDENCE.

---

**MANGANIN RODS** - RODS ALLOW FOR CUSTOM SHAPES THAT ARE NOT POSSIBLE WITH BLADES FOUND IN OTHER BRANDS. SHUNTS CAN BE CUSTOMIZED TO FIT INTO TIGHT OR ODD SHAPED SPACES AND CAN EVEN BE BUILT INTO A BUSBAR ASSEMBLY, MINIMIZING PARTS AND INVENTORY.

---

**FLEXIBILITY** - CHOICE BETWEEN STANDARD AND CUSTOM CONFIGURATIONS.

## Thermovolt – Standard 30A – 2000 Amps (+-0.5% Accuracy)

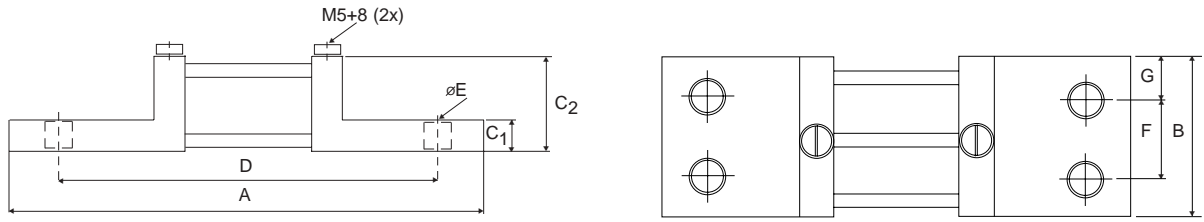

### 50 mV

Amp	Part #	Max Amp	mm (Inch)		C1	C2	D	E	F	G
			A	B						
30	15052-30	22.5	91(3.58)	20 (.79)	8 (0.32)	8 (0.32)	74 (2.92)	8 (0.32)	-	-
40	15052-40	30	91(3.58)	20 (.79)	8 (0.32)	8 (0.32)	74 (2.92)	8 (0.32)	-	-
50	15052-50	37.5	91(3.58)	20 (.79)	8 (0.32)	8 (0.32)	74 (2.92)	8 (0.32)	-	-
75	15052-75	56.3	91(3.58)	20 (.79)	8 (0.32)	8 (0.32)	74 (2.92)	8 (0.32)	-	-
100	15053-10	75	91(3.58)	20 (.79)	8 (0.32)	8 (0.32)	74 (2.92)	8 (0.32)	-	-
125	15053-12	93.8	91(3.58)	20 (.79)	8 (0.32)	8 (0.32)	74 (2.92)	8 (0.32)	-	-
150	15053-15	113	91(3.58)	20 (.79)	8 (0.32)	8 (0.32)	74 (2.92)	8 (0.32)	-	-
200	15053-20	150	140 (5.52)	30 (1.18)	10 (0.39)	30 (1.18)	100 (3.94)	13.5 (0.53)	-	-
300	15053-30	225	140 (5.52)	30 (1.18)	10 (0.39)	30 (1.18)	100 (3.94)	13.5 (0.53)	-	-
400	15053-40	300	140 (5.52)	40 (1.58)	10 (0.39)	30 (1.18)	100 (3.94)	17.5 (0.69)	-	-
500	15053-50	375	140 (5.52)	40 (1.58)	10 (0.39)	30 (1.18)	100 (3.94)	17.5 (0.69)	-	-
600	15053-60	450	140 (5.52)	40 (1.58)	10 (0.39)	30 (1.18)	100 (3.94)	17.5 (0.69)	-	-
700	15053-70	525	140 (5.52)	50 (1.97)	10 (0.39)	30 (1.18)	100 (3.94)	17.5 (0.69)	-	-
800	15053-80	600	140 (5.52)	50 (1.97)	10 (0.39)	30 (1.18)	100 (3.94)	17.5 (0.69)	-	-
900	15053-90	675	160 (6.31)	60 (2.36)	10 (0.39)	40 (1.58)	110 (4.33)	22 (0.87)	-	-
1000	15054-10	750	160 (6.31)	60 (2.36)	10 (0.39)	40 (1.58)	110 (4.33)	22 (0.87)	-	-
1200	15054-12	900	160 (6.31)	60 (2.36)	10 (0.39)	40 (1.58)	110 (4.33)	17.5 (0.69)	48 (1.89)	21 (0.83)
1500	15054-15	1125	160 (6.31)	60 (2.36)	10 (0.39)	40 (1.58)	110 (4.33)	17.5 (0.69)	48 (1.89)	21 (0.83)
2000	15054-20	1500	160 (6.31)	60 (2.36)	10 (0.39)	40 (1.58)	110 (4.33)	17.5 (0.69)	48 (1.89)	21 (0.83)
2500	15054-25	1875	160 (6.31)	120 (4.73)	10 (0.39)	40 (1.58)	110 (4.33)	22 (0.87)	60 (2.36)	30 (1.18)
3000	15054-30	2250	160 (6.31)	120 (4.73)	10 (0.39)	40 (1.58)	110 (4.33)	22 (0.87)	60 (2.36)	30 (1.18)
4000	15054-40	3000	160 (6.31)	120 (4.73)	10 (0.39)	40 (1.58)	110 (4.33)	22 (0.87)	60 (2.36)	30 (1.18)
5000	15054-50	3750	170 (7.00)	150 (5.91)	15 (0.59)	70 (2.76)	120 (4.73)	22 (0.87)	50 (1.97)	25 (0.99)
6000	15054-60	4500	170 (7.00)	150 (5.91)	15 (0.59)	70 (2.76)	120 (4.73)	22 (0.87)	50 (1.97)	25 (0.99)
8000	15054-80	6000	170 (7.00)	200 (7.88)	15 (0.59)	70 (2.76)	120 (4.73)	22 (0.87)	50 (1.97)	25 (0.99)
10000	15055-10	7500	170 (7.00)	250 (9.85)	15 (0.59)	70 (2.76)	120 (4.73)	22 (0.87)	50 (1.97)	25 (0.99)
12000	15055-12	9000	170 (7.00)	300 (11.81)	15 (0.59)	70 (2.76)	120 (4.73)	22 (0.87)	50 (1.97)	25 (0.99)

### 100 mV

Amp	Part #	Max Amp	mm (Inch)		C1	C2	D	E	F	G
			A	B						
30	110052-30	22.5	121 (4.77)	20 (0.79)	8 (0.32)	8 (0.32)	104 (4.10)	8 (0.32)	-	-
40	110052-40	30	121 (4.77)	20 (0.79)	8 (0.32)	8 (0.32)	104 (4.10)	8 (0.32)	-	-
50	110052-50	37.5	121 (4.77)	20 (0.79)	8 (0.32)	8 (0.32)	104 (4.10)	8 (0.32)	-	-
75	110052-75	56.3	121 (4.77)	20 (0.79)	8 (0.32)	8 (0.32)	104 (4.10)	8 (0.32)	-	-
100	110053-10	75	121 (4.77)	20 (0.79)	8 (0.32)	8 (0.32)	104 (4.10)	8 (0.32)	-	-
125	110053-12	93.8	121 (4.77)	20 (0.79)	8 (0.32)	8 (0.32)	104 (4.10)	8 (0.32)	-	-
150	110053-15	113	121 (4.77)	20 (0.79)	8 (0.32)	8 (0.32)	104 (4.10)	8 (0.32)	-	-
200	110053-20	150	170 (6.70)	30 (1.18)	10 (0.39)	30 (1.18)	130 (5.12)	13.5 (0.53)	-	-
300	110053-30	225	170 (6.70)	30 (1.18)	10 (0.39)	30 (1.18)	130 (5.12)	13.5 (0.53)	-	-
400	110053-40	300	170 (6.70)	30 (1.18)	10 (0.39)	30 (1.18)	130 (5.12)	17.5 (0.69)	-	-
500	110053-50	375	170 (6.70)	30 (1.18)	10 (0.39)	30 (1.18)	130 (5.12)	17.5 (0.69)	-	-
600	110053-60	450	170 (6.70)	30 (1.18)	10 (0.39)	30 (1.18)	130 (5.12)	17.5 (0.69)	-	-
700	110053-70	525	170 (6.70)	30 (1.18)	10 (0.39)	30 (1.18)	130 (5.12)	17.5 (0.69)	-	-
800	110053-80	600	170 (6.70)	30 (1.18)	10 (0.39)	30 (1.18)	130 (5.12)	17.5 (0.69)	-	-
900	110053-90	675	190 (7.49)	60 (2.36)	10 (0.39)	40 (1.58)	140 (5.52)	22 (0.87)	-	-
1000	110054-10	750	190 (7.49)	60 (2.36)	10 (0.39)	40 (1.58)	140 (5.52)	22 (0.87)	-	-
1200	110054-12	900	190 (7.49)	90 (3.35)	10 (0.39)	40 (1.58)	140 (5.52)	17.5 (0.69)	48 (1.89)	21(0.83)
1500	110054-15	1125	190 (7.49)	90 (3.35)	10 (0.39)	40 (1.58)	140 (5.52)	17.5 (0.69)	48 (1.89)	21(0.83)
2000	110054-20	1500	190 (7.49)	90 (3.35)	10 (0.39)	40 (1.58)	140 (5.52)	17.5 (0.69)	48 (1.89)	21(0.83)

**Thermovolt – Standard 300A – 1200 Amps (+-0.5% Accuracy) – CSI “Type E” mounting equivalent shunt family**

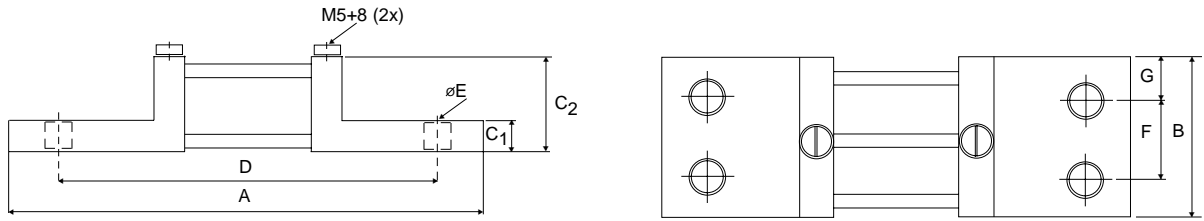

**50 mV**

Amp	Part #	Max Amp	CSI part #	Max Amp	mm (Inch)	A	B	C1	C2	D	E	F	G
300	E15053-30	225	E300-50	200	150 (5.91)	50 (1.97)	10 (0.39)	30 (1.18)	120.6 (4.75)	11 (0.43)	25.4 (1.00)	12.3 (0.48)	
400	E15053-40	300	E400-50	267	150 (5.91)	50 (1.97)	10 (0.39)	30 (1.18)	120.6 (4.75)	11 (0.43)	31.8 (1.25)	9.1 (0.36)	
500	E15053-50	375	E500-50	333	150 (5.91)	50 (1.97)	10 (0.39)	30 (1.18)	120.6 (4.75)	11 (0.43)	31.8 (1.25)	9.1 (0.36)	
600	E15053-60	450	E600-50	400	150 (5.91)	50 (1.97)	10 (0.39)	30 (1.18)	120.6 (4.75)	11 (0.43)	38.1 (1.50)	9.1 (0.36)	
800	E15053-80	600	E800-50	533	150 (5.91)	60 (2.36)	10 (0.39)	30 (1.18)	120.6 (4.75)	11 (0.43)	31.8 (1.25)	10.95 (0.43)	
1000	E15054-10	750	E1000-50	667	150 (5.91)	60 (2.36)	10 (0.39)	30 (1.18)	120.6 (4.75)	11 (0.43)	31.8 (1.25)	10.95 (0.43)	
1200	E15054-12	900	E1200-50	800	150 (5.91)	60 (2.36)	10 (0.39)	30 (1.18)	120.6 (4.75)	11 (0.43)	31.8 (1.25)	10.95 (0.43)	

**100 mV**

Amp	Part #	Max Amp	CSI part #	Max Amp	mm(Inch)	A	B	C1	C2	D	E	F	G
300	E110053-30	225	E300-100	200	150 (5.91)	50 (1.97)	10 (0.39)	30 (1.18)	120.6 (4.75)	11 (0.43)	25.4 (1.00)	12.3 (0.48)	
400	E110053-40	300	E400-100	267	150 (5.91)	50 (1.97)	10 (0.39)	30 (1.18)	120.6 (4.75)	11 (0.43)	25.4 (1.00)	12.3 (0.48)	
500	E110053-50	375	E500-100	333	150 (5.91)	50 (1.97)	10 (0.39)	30 (1.18)	120.6 (4.75)	11 (0.43)	25.4 (1.00)	12.3 (0.48)	
600	E110053-60	450	E600-100	400	197.6 (7.78)	50 (1.97)	10 (0.39)	30 (1.18)	168.2 (6.62)	11 (0.43)	31.8 (1.25)	9.1 (0.36)	
800	E110053-80	600	E800-100	533	197.6 (7.78)	60 (2.36)	10 (0.39)	30 (1.18)	168.2 (6.62)	11 (0.43)	31.8 (1.25)	10.95 (0.43)	
1000	E110054-10	750	E1000-100	667	197.6 (7.78)	60 (2.36)	10 (0.39)	30 (1.18)	168.2 (6.62)	11 (0.43)	31.8 (1.25)	10.95 (0.43)	
1200	E110054-12	900	E1200-100	800	197.6 (7.78)	60 (2.36)	10 (0.39)	30 (1.18)	168.2 (6.62)	11 (0.43)	31.8 (1.25)	10.95 (0.43)	

**Thermovolt – Standard 1000A – 3000 Amps (+-0.5% Accuracy) – CSI “Type FL” mounting equivalent shunt family**

**50 mV**

Amp	Part #	Max Amp	CSI part #	Max Amp	mm(Inch)	A	B	C1	C2	D	E	F	G
1000	FL15054-10	750	FL1000-50	666	96.1 (3.79)	50 (1.97)	10 (0.39)	30 (1.18)	76.2 (3.00)	10.5 (0.41)	25.4 (1.00)	12.3 (0.48)	
1200	FL15054-12	900	FL1200-50	800	96.1 (3.79)	50 (1.97)	10 (0.39)	30 (1.18)	76.2 (3.00)	10.5 (0.41)	25.4 (1.00)	12.3 (0.48)	
1500	FL15054-10	1125	FL1500-50	1000	92.9 (3.66)	50 (1.97)	10 (0.39)	30 (1.18)	72.9 (2.87)	10.5 (0.41)	25.4 (1.00)	12.3 (0.48)	
2000	FL15054-20	1500	FL2000-50	1333	89.9 (3.54)	50 (1.97)	10 (0.39)	30 (1.18)	69.9 (2.75)	10.5 (0.41)	25.4 (1.00)	12.3 (0.48)	
2500	FL15054-25	1875	FL2500-50	1666	86.5 (3.41)	50 (1.97)	10 (0.39)	30 (1.18)	66.5 (2.62)	10.5 (0.41)	25.4 (1.00)	12.3 (0.48)	
3000	FL15054-30	2250	FL3000-50	2000	83.5 (3.29)	50 (1.97)	10 (0.39)	30 (1.18)	63.5 (2.50)	10.5 (0.41)	25.4 (1.00)	12.3 (0.48)	

**100 mV**

Amp	Part #	Max Amp	CSI part #	Max Amp	mm(Inch)	A	B	C1	C2	D	E	F	G
1000	FL110054-10	750	FL1000-100	666	108.9 (4.29)	50 (1.97)	10 (0.39)	30 (1.18)	88.9 (3.50)	10.5 (0.41)	25.4 (1.00)	12.3 (0.48)	
1200	FL110054-12	900	FL1200-100	800	108.9 (4.29)	50 (1.97)	10 (0.39)	30 (1.18)	88.9 (3.50)	10.5 (0.41)	25.4 (1.00)	12.3 (0.48)	
1500	FL110054-12	1125	FL1500-100	1000	105.6 (4.16)	50 (1.97)	10 (0.39)	30 (1.18)	85.6 (3.37)	10.5 (0.41)	25.4 (1.00)	12.3 (0.48)	
2000	FL110054-20	1500	FL2000-100	1333	102.6 (4.04)	50 (1.97)	10 (0.39)	30 (1.18)	82.6 (3.25)	10.5 (0.41)	25.4 (1.00)	12.3 (0.48)	
2500	FL110054-25	1875	FL2500-100	1666	99.2 (3.90)	50 (1.97)	10 (0.39)	30 (1.18)	79.2 (3.12)	10.5 (0.41)	25.4 (1.00)	12.3 (0.48)	
3000	FL110054-30	2250	FL3000-100	2000	96.2 (3.79)	50 (1.97)	10 (0.39)	30 (1.18)	76.2 (3.00)	10.5 (0.41)	25.4 (1.00)	12.3 (0.48)	

**Tecknowledgey**<sup>®</sup>

Tecknowledgey Inc.

8 John Walsh Boulevard, Peekskill, NY 10566

Phone: 914 739-4499

Fax: 914 739-5599

Email: [info@tecknowledgey.com](mailto:info@tecknowledgey.com)

Web: [www.tecknowledgey.com](http://www.tecknowledgey.com)