

Inductive

30 mm Diameter DC 3/4 Wire

FEATURES:

- Short circuit & reverse polarity protection
- Protection degree IP67: dust tight and protection from the effects of immersion
- LED function indicator
- +100° C high temperature version available upon request
- 3.5, 5, 7.5 and 10 meter cable lengths available upon request

| | | MODEL | | | |
|----------------------------------|------------|---------------------|--------------|--------------|--------------|
| Output Function | NPN, NO | S3470 | S3474 | S3110 | S3114 |
| | NPN, NC | S3471 | S3475 | S3111 | S3115 |
| | PNP, NO | S3472 | S3476 | S3112 | S3116 |
| | PNP, NC | S3473 | S3477 | S3113 | S3117 |
| | NPN, NO+NC | S3690 | S3693 | S3118 | S3120 |
| | PNP, NO+NC | S3691 | S3694 | S3119 | S3121 |
| Dimensions: mm 1 mm = .03937" | | | | | |
| Operating Distance (Sn) | | 10 mm | 15 mm | 10 mm | 15 mm |
| External Diameter | | M30 x 1.5 | | | |
| Power Supply | | 10 - 30 Vdc | | | |
| Max Switching Current | | 200 mA | | | |
| Power Drain (24Vdc) | | < 15 mA | | | |
| Voltage Drop (sensor ON) | | < 1.8 V | | | |
| Short Circuit Protection | | Yes | | | |
| Operating Frequency | | 300 Hz | | | |
| Repeatability (%Sn) | | ≤ 3% | | | |
| Hysteresis (%Sn) | | < 10% | | | |
| Case | | Nickel-plated brass | | | |
| Flush Mounting | | Yes | No | Yes | No |
| Protection Degree | | IP 67 | | | |
| Operating Temperature | | - 25 to +70 °C * | | | |
| Output Connection | | Cable PVC: L = 2 m | | Connector C | |

* +100° C high temperature version available upon request

WIRING:

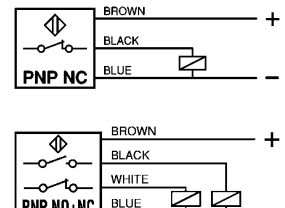
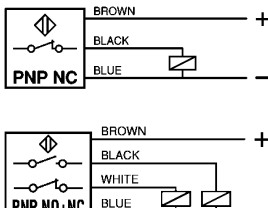
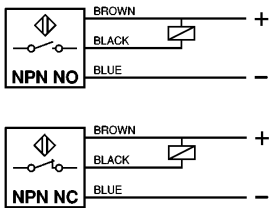

30 mm Diameter DC 3/4 Wire "Short Series"

FEATURES:

- Extended operating distance
- Short circuit & reverse polarity protection
- Protection degree IP67: dust tight and protection from the effects of immersion
- +100° c high temperature version available upon request
- 3.5, 5, 7.5 and 10 meter cable lengths available upon request

| | | MODEL | | | |
|----------------------------------|------------|---------------------|--------------|--------------|--------------|
| Output Function | NPN, NO | S3130 | | S3134 | |
| | NPN, NC | S3131 | | S3135 | |
| | PNP, NO | S3132 | | S3136 | |
| | PNP, NC | S3133 | | S3137 | |
| | NPN, NO+NC | | S3680A | | S3684A |
| | PNP, NO+NC | | S3682A | | S3686A |
| Dimensions: mm 1 mm = .03937" | | | | | |
| Operating Distance (Sn) | | 15 mm | 20 mm | 15 mm | 20 mm |
| External Diameter | | M30 x 1.5 | | | |
| Power Supply | | 10 - 30 Vdc | | | |
| Max Switching Current | | 200 mA | | | |
| Power Drain (24Vdc) | | < 15 mA | | | |
| Voltage Drop (sensor ON) | | < 1.8 V | | | |
| Short Circuit Protection | | Yes | | | |
| Operating Frequency | | 300 Hz | 200 Hz | 300 Hz | 200 Hz |
| Repeatability (%Sn) | | ≤ 3% | | | |
| Hysteresis (%Sn) | | < 10% | | | |
| Case | | Nickel-plated brass | | | |
| Flush Mounting | | Yes | No | Yes | No |
| Protection Degree | | IP 67 | | | |
| Operating Temperature | | - 25 to +70 °C * | | | |
| Output Connection | | Cable PVC: L = 2 m | | Connector C | |

* +100° C high temperature version available upon request

CONNECTOR:

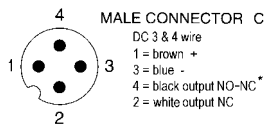

* In the 3 wire sensors with type C connector and NC output the pins 2 & 4 are internally wired together

MATING CONNECTORS:

- | | | |
|-----------|------|------------------------------|
| ID# | Type | Description |
| 3 wire | | |
| S3494 | C | right angle w/ 2 meter cable |
| S3495 | C | right angle w/ 5 meter cable |
| S3497 | C | straight w/ 2 meter cable |
| S3498 | C | straight w/ 5 meter cable |
| 4 wire | | |
| S3496/2 C | | right angle w/ 2 meter cable |
| S3496 | C | right angle w/ 5 meter cable |
| S3499/2 C | | straight w/ 2 meter cable |
| S3499 | C | straight w/ 5 meter cable |

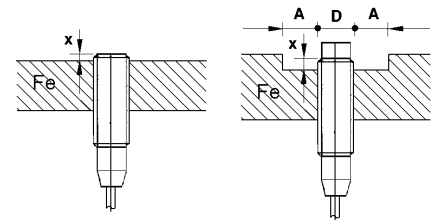

flush mounting
X ≥ 4 mm
15 mm Sn only

Non flush mounting
X ≥ 10 mm A ≥ 2D
20 mm Sn only

Inductive

30 mm Diameter DC 2 Wire

FEATURES:

- Only 2 wires for easy installation
- Short circuit protection
- Protection degree IP67: dust tight and protection from the effects of immersion
- LED function indicator
- +100° C high temperature version available upon request
- 3.5, 5, 7.5 and 10 meter cable lengths available upon request

| | | MODEL | | | |
|----------------------------------|----|---------------------|--------------|--------------|--------------|
| Output Function | NO | S3140 | S3141 | S3142 | S3143 |
| | NC | S3144 | S3145 | S3146 | S3147 |
| Dimensions: mm 1 mm = .03937" | | | | | |
| Operating Distance (Sn) | | 10 mm | 15 mm | 10 mm | 15 mm |
| External Diameter | | M30 x 1.5 | | | |
| Power Supply | | 10 - 55 Vdc | | | |
| Max Switching Current | | 100 mA | | | |
| Min Switching Current | | 1.5 mA | | | |
| Residual Current | | < 0.6 mA | | | |
| Voltage Drop (sensor ON) | | < 6.5 V | | | |
| Short Circuit Protection | | Yes | | | |
| Operating Frequency | | 300 Hz | | | |
| Repeatability (%Sn) | | ≤ 3% | | | |
| Hysteresis (%Sn) | | < 10% | | | |
| Case | | Nickel-plated brass | | | |
| Flush Mounting | | Yes | No | Yes | No |
| Protection Degree | | IP 67 | | | |
| Operating Temperature | | - 25 to +70 °C * | | | |
| Output Connection | | Cable PVC: L = 2 m | | Connector C | |

* +100° C high temperature version available upon request

These sensors contain an output amplifier with the function NO or NC that can pilot a load connected in series. In this system a residual current flows through the load even when in the open state and a voltage drop occurs to the sensor when it is in the closed state. Attention must be paid to these restrictions when selecting relays or electronic controls to be used with these sensors. They are adapted for inputs of programmable controllers.

WIRING:

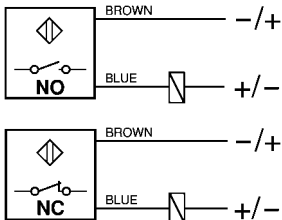

CONNECTOR:

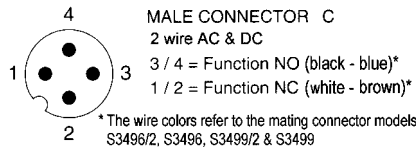

MATING CONNECTORS:

| ID# | Type | Description |
|-----------|------|------------------------------|
| S3496/2 C | | right angle w/ 2 meter cable |
| S3496 C | | right angle w/ 5 meter cable |
| S3499/2 C | | straight w/ 2 meter cable |
| S3499 C | | straight w/ 5 meter cable |

30 mm Diameter AC 2 Wire

FEATURES:

- Protection degree IP67: dust tight and protection from the effects of immersion
- LED function indicator
- +100° C high temperature version available upon request
- 3.5, 5, 7.5 and 10 meter cable lengths available upon request

| | | MODEL | | | |
|----------------------------------|----|---------------------|--------------|--------------|--------------|
| Output Function | NO | S3288 | S3290 | S3300 | S3302 |
| | NC | S3289 | S3291 | S3301 | S3303 |
| Dimensions: mm 1 mm = .03937" | | | | | |
| Operating Distance (Sn) | | 10 mm | 15 mm | 10 mm | 15 mm |
| External Diameter | | M30 x 1.5 | | | |
| Power Supply | | 20 - 250 Vac | | | |
| Max Switching Current | | 300 mA | | | |
| Min Switching Current | | 5 mA | | | |
| Max Peak Current for 20ms | | 1.5 A | | | |
| Residual Current | | < 1 mA | | | |
| Voltage Drop | | < 6 V | | | |
| Operating Frequency | | 12 Hz | | | |
| Repeatability (%Sn) | | ≤ 3% | | | |
| Hysteresis (%Sn) | | < 10% | | | |
| Case | | Nickel-plated brass | | | |
| Flush Mounting | | Yes | No | Yes | No |
| Protection Degree | | IP 67 | | | |
| Operating Temperature | | - 25 to +70 °C * | | | |
| Output Connection | | Cable PVC: L = 2 m | | Connector C | |

* +100° C high temperature version available upon request

These are two-wire sensors that contain a thyristor output amplifier in addition to the oscillator. Attention must be paid to the minimum switching current, residual current and voltage drop when selecting low consumption relays or high impedance electronic controls to be used with these sensors. They are adapted for inputs of programmable controllers.

WIRING:

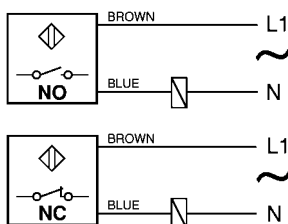

CONNECTOR:

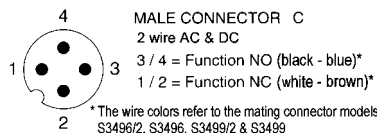

MATING CONNECTORS:

| ID# | Type | Description |
|---------|------|------------------------------|
| S3496/2 | C | right angle w/ 2 meter cable |
| S3496 | C | right angle w/ 5 meter cable |
| S3499/2 | C | straight w/ 2 meter cable |
| S3499 | C | straight w/ 5 meter cable |